

Operating Instructions



 Cincom

 www.cincomhealth.com

Email: service@cincomhealth.com

SHENZHEN CINCOM E-COMMERCE CO., LTD.
Address: B806, building 11, gongyuandadixiaoqu, Longxiangdadao
Longchengjiedao, longgangqu, shenzhen, guangdong, China
E-mail: service@cincomhealth.com
Website: www.cincomhealth.com



Air Compression Leg Massager

CM-028A



 Please read instructions carefully before use and keep it well for further reference.

Contents

Safety Precautions-----	1
FAQs -----	2
Troubleshooting -----	3
Product Charging Instructions -----	3
Usage Of The Sleeves -----	3
Usage Of The Controller -----	4
Notes after Use -----	5
Cleaning and Storage -----	5
Disposal -----	6
Specifications-----	6
Package Includes -----	6
Contact Us-----	6

Safety Precautions

Warnings

- 1.Those with any of the following conditions or persons who are receiving medical treatment should consult the doctor before using the machine:
 - 1)Using pacemaker or other medical devices which are susceptible to electrical interference;
 - 2)Suffering from malignant tumors;
 - 3)Suffering from cardiac diseases;
 - 4)Having serious peripheral neuropathy dysfunction or sensory disturbance caused by diabetes;
 - 5)Being unsuitable to do the massage because of traumas on the body;
- 2.Keep it out of the reach of infants, children and people without the ability to use it independently.
- 3.Don't use other power adapter but the original one.
- 4.Don't scratch, damage, process, excessively bend, pull or twist the power cord of power adapter. Otherwise, it may cause fire or electric shock.
- 5.It is not allowed to use when the power adapter dysfunctions or the plug is loose.
- 6.Don't plug or unplug the power adapter with wet hands.
- 7.Don't put the controller in the quilt or use the machine in high temperature condition.
- 8.It is forbidden to remodel, disassemble or repair the machine without permission.



Cautions

- 1.Stop using it immediately if you feel unwell. Don't use it again before consult the doctor.
- 2.Don't use it in bathroom or other humid places.
- 3.Unplug the power adapter from the socket before you clean and maintain it.
- 4.Unplug the power adapter when you are not using it.

FAQS

Q1: How does this product massage?

A1: There are 2+2 airbags inside. It will be inflated and deflated to simulate kneading and stroking of tissues like human hands. It can relax our muscles, increase circulation and relieve pain.

Q2: How many massage modes, and what's the difference?

A2: There are 3 massage modes,

Mode 1: Sequence Mode

In this mode, sleeves will be inflated and deflated from lower to upper.

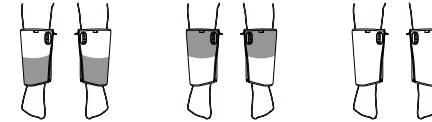

Mode 1: Sequence Mode

Mode 2: Circulation Mode

In this mode, sleeves will be inflated and deflated circularly from lower to upper.

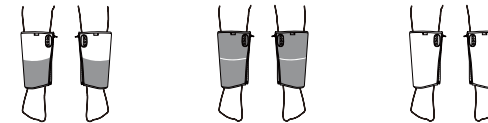

Mode 2: Circulation Mode

Mode 3: Whole Mode

In this mode, sleeves will be inflated and deflated simultaneously and wholly.

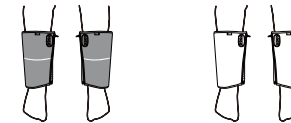

Mode 3: Whole Mode,

Q3: What should I do if I feel the massage strength is too light or too tight?

A3: There are 3 levels of massage strength selectable via the controller, please select the intensity which is fit for you. You can also adjust the strength via changing the tightness of Velcro on the wraps.

Q4: How long should we use it?

A4: We suggest you use it 2~3 times everyday, and 20 minutes per time. You can also use it for long time if you feel too tired or want to continue to enjoy.

Q5: Why does the controller get hot?

A5: As we suggested, you can use it 20 minutes per time normally. If it keeps working too long, the controller will get hot, it's a normal phenomenon.

Q6: Why does the controller make a sound?

A6: The sound comes from the working air pump in the controller, providing air continuously to the airbags in the wraps, it's a normal phenomenon.

Troubleshooting

Problems	Causes & Solutions
1. Doesn't work and Indicator light is off	Make sure the power adapter is connected well and press the power button of the controller.
2. Break off during operation	The massager will shut off automatically in 20 minutes.
3. Too light or tight.	1. There are three massage levels to choose. 2. You can adjust the width of the wrap to make the strength suitable. 3. Turn off the machine if you cannot bear the strength.
4. The controller gets hot.	It is normal if the controller gets hot after long time use. We suggest you can shut it down for 10 minutes.

Product Charging Instructions

1. For first charging, please make sure the machine is fully recharged, which is good for the battery.
2. If the light of the power button is flashing, it means that the machine is out of power. You can continue to use it by the adapter, or stop use it until it is fully recharged.
3. When it is recharging, the indicator of power button keeps flashing; and when it is fully recharged, the indicator is always on.

Usage Of The Sleeves

Cautions: please read Safety Precautions carefully before use. In order to get better massage, please wear the sleeves properly.

For Calves:

1. Wear the wraps on calves correctly as below.

Midline position

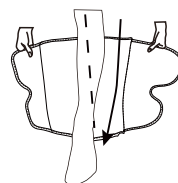
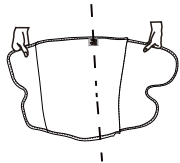

left leg

3

2. Check and adjust the position and tightness, don't wrap too tight.

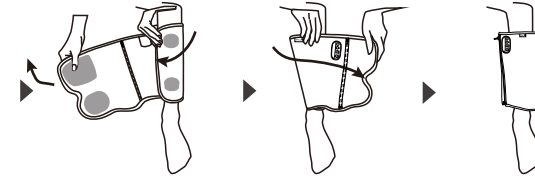

For Feet

1. Wear the wraps on feet correctly as below.



left foot

2. Check and adjust the position and tightness, don't wrap too tight.

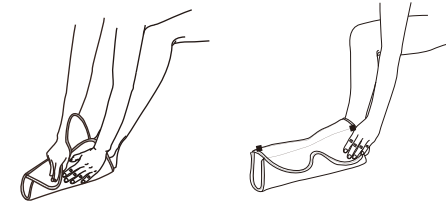

* Don't tie wraps too tightly and leave some gap as possible for the first use.

Usage Of The Controller

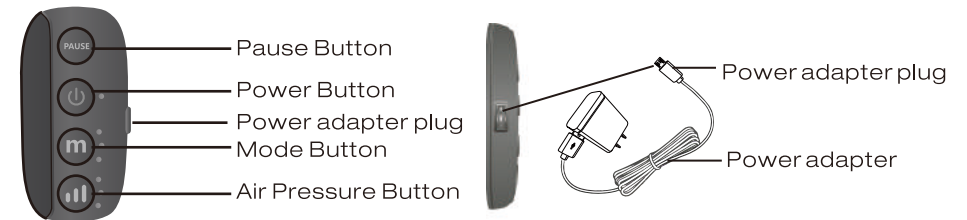

1. Press "⏻" button and hold for three seconds to start the machine:
 - It will begin with mode 1 and strength 1 (The lowest) by default.
 - It will shut off after 20 minutes (You can restart it manually).
2. Press "m" button to switch and enjoy the different massage modes, the difference between these 3 modes can be seen on Page 2.
3. Press "||" button to select intensity.
 - 1) Three pressure levels for choice. We suggest you use the lowest level at the beginning.
 - 2) You can change the tightness of the wraps to make the strength suitable as you like.

4

4. You can press “” to pause massage anytime, and it will continue to massage when you press it again.

5. Press the “” button to end the massage.

 **Warnings:** We suggest using it 20mins each time as the best. After 20-minute work, it will shut down automatically but you can restart it.

Notes after use

1. Smart design for the zipper, more convenient for you to wear on or take off the sleeves.



2. Unplug the power adapter from the socket.



3. Take off the wraps, fold it into the storage bag or box.

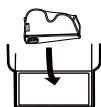

Cleaning

Make sure to cut off the power when you clean the machine.

1. If dirty, please wipe the machine with a soft cloth moistened by soap solution.
2. Don't use gasoline, alcohol, diluent and other irritating liquid to wipe the machine in case it causes malfunction or the components are damaged or discolored.
3. Toothpicks can be used to remove the hair or chippings attached on the Velcros.



Storage

- Keep it out of the reach of children
- Don't disassemble the machine by yourself.
- Don't place it in high temperature and humidity condition.
- Avoid direct sunlight.
- Avoid needles puncture the air bags and hoses.
- Don't place heavy stuff on it.



Disposal

Please adhere to the local regulations when you dispose of the wasted

Specifications

Model	CM-028A
Name	Air Compression Leg Massager
AC/DC Adapter	AC Input: 100~240 Volts, AC 50/60Hz, DC Output: 5V 2A
Rated power	10W
Operating Conditions	Temperature: +5°C to 40°C (41°F to 104°F) Humidity: 1% to 90% non-condensing Atmospheric Pressure: 70 kPa to 106 kPa
Storage Conditions	Temperature: -20°C to 55°C Humidity: 5% to 90% non-condensing Atmospheric Pressure: 50 kPa to 106 kPa Keep dry and avoid direct sunlight exposure.
Timing	20 minutes

Package Included

- 2 x Leg Massager Wraps
- 1 x Power Adapter/ DC5V 2A
- 1 x User Manual
- 1 x Portable Storage Bag

Contact us

We provide 2-year warranty and long-term after-sale service. If you have any problems during using of this product, please feel free to contact us. Our professional customer service team will help you!

E-mail: service@cincomhealth.com

Note: Please include the order number together with the problems you meet in the mail.

 **Cincom**

 www.cincomhealth.com

Email: service@cincomhealth.com