

**Air Compression Leg Massager With Heat**



**Operating Instructions**

Thanks for purchasing our product. Please read the instructions carefully before use and keep it well for further reference.

**Contents**

Safety Precautions ..... 1  
 FAQs ..... 2  
 Product Description ..... 4  
 Operating Instructions..... 5  
 Maintenance..... 8  
 Storage..... 8  
 Disposal..... 8  
 Troubleshooting..... 9  
 Specifications..... 10  
 Package Includes..... 10  
 Warranty ..... 10

**SAFETY PRECAUTIONS**

**Warnings**

- Those with any of the following conditions or persons who are receiving medical treatment should consult the doctor before using the product:
  - Using pacemaker or other medical devices which are susceptible to electrical interference;
  - Suffering from malignant tumors;
  - Suffering from cardiac diseases;
  - Having serious peripheral neuropathy dysfunction or sensory disturbance caused by diabetes;
  - Being unsuitable to do the massage because of traumas on the body;
- Keep it out of the reach of infants, children, and people without the ability to use it independently.
- Don't use another power adapter but the original one.
- Don't scratch, damage, process, excessively band, pull or twist the power cord of power adapter. Otherwise, it may cause fire or electric shock.
- It is not allowed to use when the power adapter dysfunctions or the plug is loose.

- Don't plug or unplug the power adapter with wet hands.
- Don't put the controller in the quilt or use the machine in high temperature condition.
- It is forbidden to remodel, disassemble or repair the product without permission.



**Cautions**

- Stop using it immediately if you feel unwell. Don't use it again before consulting the doctor.
- Don't use it in the bathroom or other humid places.
- Unplug the power adapter from the socket before you clean and maintain it.
- Unplug the power adapter when you are not using it.
- Don't walk around when you are using this item or wearing the wraps.

**FAQs**

- Q1: How does this product massage?**  
 A1: There are 4 large airbag chambers in each sleeve(foot, lower calf, upper calf and thigh) inflated and deflated with a sophisticated sequence to stimulate hand kneading and stroking, maximizes blood flow throughout the body to help with reduced muscle soreness and/or pains to the treated areas, and enhanced circulation.
- Q2: How many massage modes, and what's the difference?**  
 A2: There are 3 massage modes.  
**Mode1: Sequence Mode**  
 Foot & Lower Calf chamber compress and hold pressure → Upper Calf & Thigh chamber compress and hold pressure → all 4 chambers release at the same time. There will be a brief rest period and then the cycle will begin again. This will repeat until the session time runs out.



- Mode 2: Circulation Mode**  
 Foot & Lower Calf chamber compress and hold pressure → Upper Calf & Thigh chamber compress and hold pressure → all 4 chambers release at the same time. There will be a brief rest period and then the cycle will begin again. This will repeat until the session time runs out.

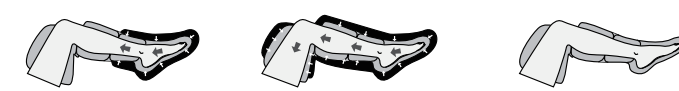

- Mode 3: Combination Mode**  
 Mode 1 and mode 2 runs alternately in this mode until the session time runs out.

- Q3: What should I do if I feel the massage strength is too light or too tight?**  
 A3: There are 3 levels of massage intensity selectable via the control unit, please select the intensity which is fit for you. If you still feel it's too strong at the lowest setting, please stop using the device, we suggest to consult your doctor before next use.
- Q4: How long should I use it?**  
 A4: It is recommended to use it once or twice a day, no more than 30 minutes at a time. But you can use it longer if you feel too tired and want it massage longer to work on the soreness.
- Q5: Why does it not work when I press the power button?**  
 A5: Please ensure both 2 air hoses are inserted into the controller, otherwise, it will not work.
- Q6: Why does the controller get hot?**  
 A6: As we suggested, you can use it 20 minutes per time normally. If it keeps working too long, the controller will get hot, that's a normal phenomenon.
- Q7: Why does the controller make sound?**  
 A7: The sound comes from the working air pump in the controller, providing air continuously to the airbags in the wraps, that's normal.
- Q8: What should I do if I feel the temperature is too hot?**  
 A8: Heating function is optional, we suggest you to use it over pants, and there are 3 different heating levels to choose.

the lowest level from the beginning. If you still feel hot at the lowest level, please turn it off or stop using it.

**PRODUCT DESCRIPTION**

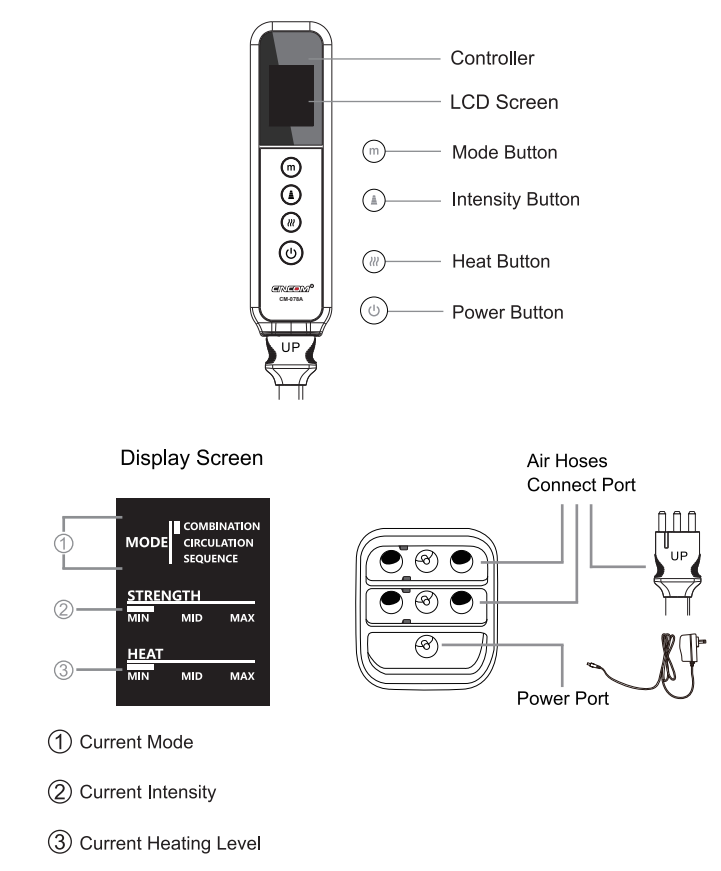

SHENZHEN CINCOM E-COMMERCE CO.,LTD.  
 D1504, Building 3, Phase 1, Tianan Cloud Park, Shenzhen, 51829, China.

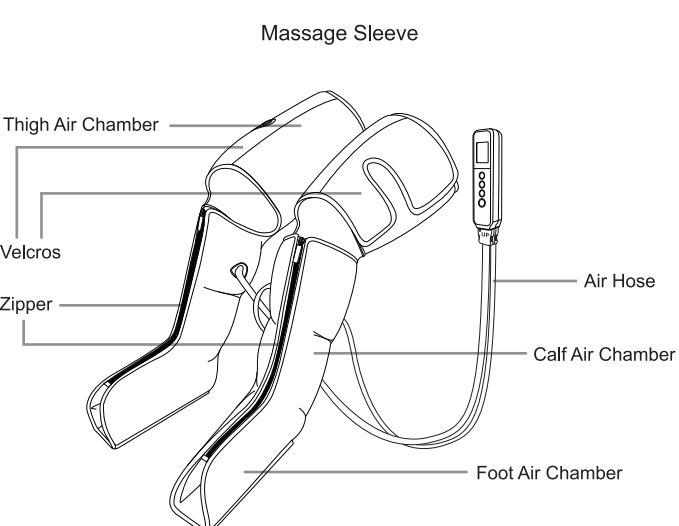

**OPERATING INSTRUCTIONS**

Please read safety precautions carefully before using the product. In order to get better massage, please use it according to the instruction  
 1. Fix the velcros of thigh part, adjust the position and tightness, don't wrap too tight.

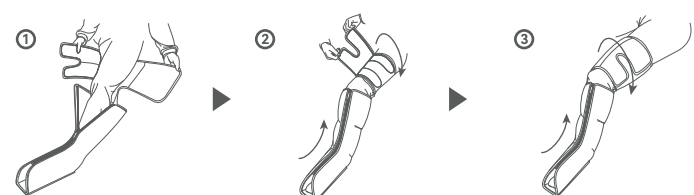

- Check the tags for Left / Right Leg, then wear the sleeve properly. You can keep the foot and calf part zipped and slip you leg in like putting on pant, or you can make it fully opened, put your leg in and then zip the sleeve.

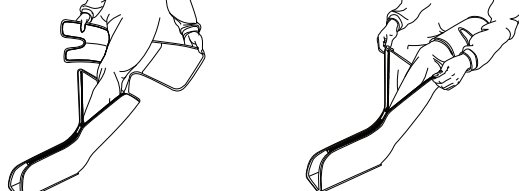

Note, never try to use the device with the zipper partially or totally unzipped  
 3. Insert BOTH two air hoses into the controller correctly and completely, then connect well the adapter to the outlet and controller.

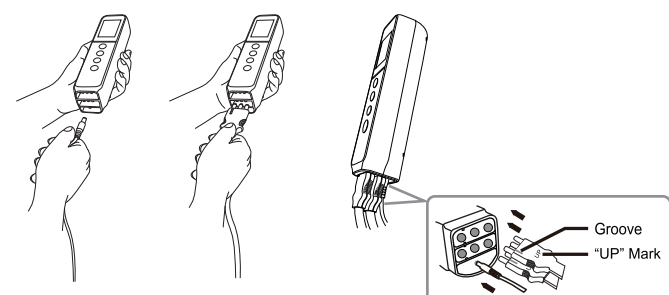

- Press the Power button (P) to start. It will begin with Mode 1 / Min air pressure intensity / Heat off by default.

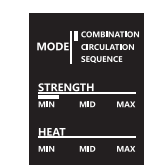

- Press Mode button (M) to change the massage mode. 3 modes available, see the difference in FAQs A2.

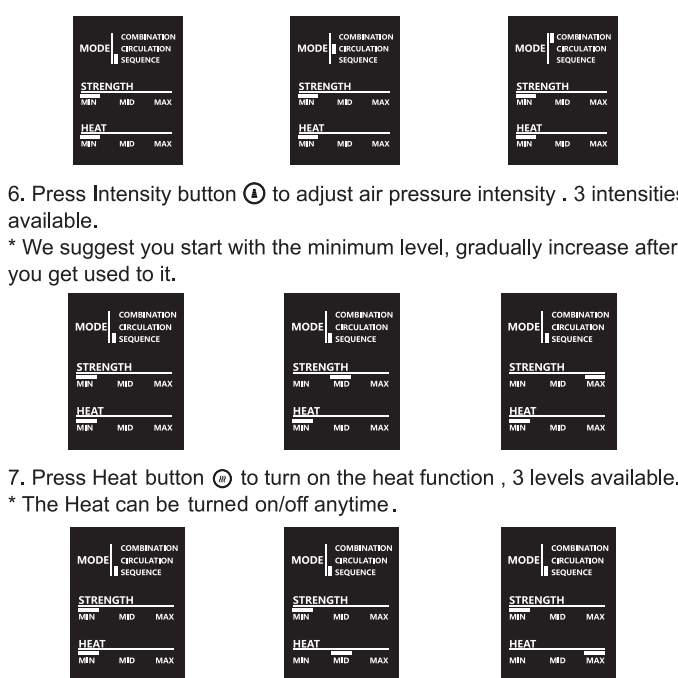

Note: The device will automatically shut off after 20 mins operation, if you wanna enjoy more or end the massage earlier, press the Power button to turn it on / off.

**Notes After Use**

- Unplug the power adapter from the socket

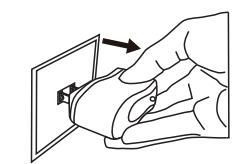

- Pull out the power adapter and air hoses from the bottom of the controller.

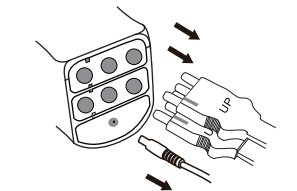

- Take off the wraps, fold them into the storage bag or box.

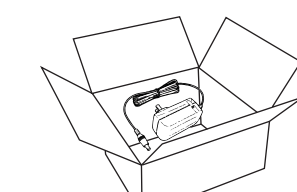

**MAINTENANCE**

- Make sure to cut off the power before you clean the device
- If dirty, please wipe with a soft cloth moistened by soap solution.
  - Don't use gasoline, alcohol, diluent, and other irritating liquid to wipe the machine, in case it causes malfunction or the components are damaged or discolored.
  - Do not hold the device under running water, do not submerge it in water or other liquids.
  - Don't allow foreign matters to enter the hoses.
  - Toothpicks can be used to remove the hair or chippings attached to the Velcros.
  - Don't disassemble the machine by yourself.

**STORAGE**

- Keep it out of the reach of children.
- Don't place it in high temperature and humidity conditions.

- Avoid direct sunlight.
- Avoid needles puncture the airbags.
- Don't place heavy stuff on it.

**DISPOSAL**

Please adhere to the local regulations when you dispose of the wasted

**TROUBLE SHOOTING**

Problems	Possible Causes	Solutions
Doesn't work and screen is off	1. Power is not turned on. 2. Adapter is not securely connected. 3. Faulty wall outlet.	1. Press the power button to turn the control unit on. 2. Make sure the power adapter is connected well to the control unit and the wall outlet. 3. Check if the wall outlet works.
The screen is on but the sleeves doesn't work	1. Only connect one of the sleeves with the air hose. 2. Air hoses are not securely connected. 3. The sleeves have been damaged.	1. It works only when 2 sleeves are connected to the air hose. 2. Please check if the air hoses are inserted correctly and completely to the control unit and the junction box (pay attention to the 'UP' mark). 3. Check if the sleeves have an air leak, if there is, please contact our customer service at service@cincomhealth.com
Break off during operation or stop pumping	1. Air hoses are not securely connected. 2. The power adapter falls off. 3. The treatment session time is up.	1. Please check if the air hoses are inserted correctly and completely to the control unit and the junction box (pay attention to the 'UP' mark). 2. Make sure the power adapter is connected well to the control unit and the wall outlet. 3. The device will shut off automatically after 20 mins operation, press the power button to restart it if needed;

**SPECIFICATIONS**

Product name	Air Compression Leg Massager With Heat
Model NO.	CM-078A
Rated Voltage	AC 100~240V 50/60Hz , DC12V/3A
Rated Power	36W
Weight	2.2kg / 4.8 lbs
Pressure Intensity	3 intensities: Min. Mid. Max
Compression Mode	3 Modes ; Sequence, Circulation, Combination
Timer	20 Minutes Auto Off
Heating Levels	Min. Mid. Max
Heating Temperature	Test at ambient temperature 25°C, High:543°C; Low:537°C Test at ambient temperature 40°C, High:50°C; Low:545°C
Operating Conditions	Temperature: +5°C to 40°C ; Humidity : 5% to 90% non-condensing; Atmospheric Pressure : 75 kPa to 106 kPa
Storage Conditions	Temperature: -20°C to 55°C ; Humidity : 5% to 90% non-condensing; Atmospheric Pressure : 75 kPa to 106 kPa; Keep dry and avoid direct sunlight.

**PACKAGE INCLUDES**

- 2 x Massage Warps (with air hose)
- 1 x Handheld Controller
- 1 x User Manual
- 1 x Power Adapter/ DC12V3A
- 1 x Portable Storage Bag
- 1 x quick guide

**WARRANTY**

CINCOM has made every effort to ensure your product is as strong and durable as possible. However, it is still possible that some mishaps could happen and we take full responsibility. If the air compression, the battery or the programs start to malfunction, please contact us at service@cincomhealth.com.

Note: Please include the order number along with the problems you meet in the mail, videos & pictures are welcomed for better and faster service.

尺寸: 105\*148MM (6折页)  
 名称: CM-078A  
 材质: 157G铜版纸  
 版本号: